

RoadWay Vision Systems Field Box

The Remote Vision System Field Box is an economical, robust CCTV field mounted accessory that provides an assortment of camera power, data, local camera setup and communications capability in a small foot print assembly.



Model Number - RVSFB120X



Features:

- Surge suppression on data, video and power lines.
- Video output for test monitor connection.
- Plug-in connection for joystick controllers.
- Manual switch to select either joystick, laptop or remote (head end) PTZ control.
- AC receptacle for local test monitor.
- Available with NEMA 4x enclosure.
- Small Footprint : 7"W x 9.5"H x 5.5"D

282 Treehaven Ave.
Powell, OH 43065
Phone: 614.791.8843
Fax: 614.789.0252
www.treehaven.tv

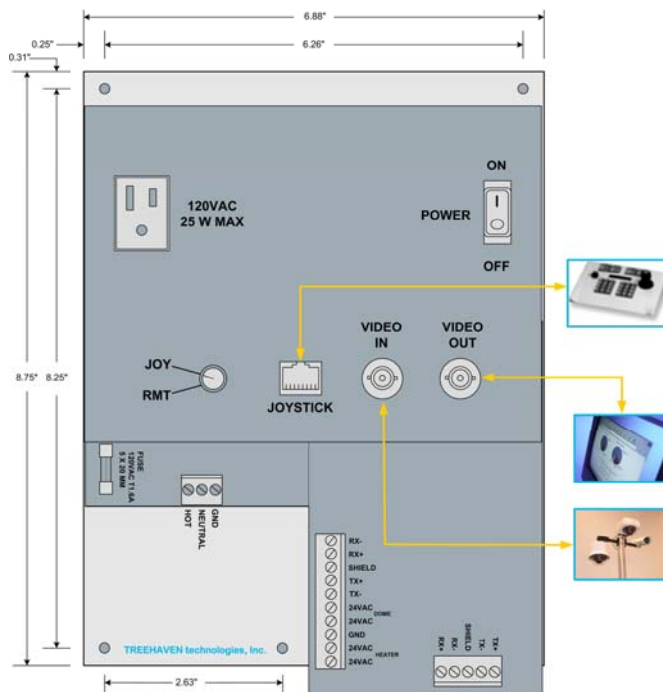

Specifications:

Model RVSFB:

- RVS = RoadWay Vision System
- FB = Field Box
- 120 = Voltage (120 or 240)
- E = Enclosure Included
- R = Rack Mount
- S = Optional Speed-On-Video
- W = Optional Weight-On-Video
- A = Network Video Server
- L = Enhanced Surge Suppression
- F = Fixed Camera
- T = Terminal Strip Only
- X = Small Footprint

Electrical:

- AC Input Voltage: 120VAC 50/60 Hz, 1.8A
- Dome Power Output: 24V, 50/60 Hz, 1.25 A
- Heater Power Output: 24V, 50/60 Hz, 5A

Environmental:

- Operating Temperature: -10°F (-23°C) to 140°F (60°C)
- Humidity: 5% to 95%, non-condensing

Data:

- Joystick: RS-422, Rx+, Rx-, Tx+, Tx-
- Laptop: RS-232, TX, Rx, Gnd
- Remote Control: RS-422, Rx+, Rx-, Tx+, Tx-

Video:

- Camera Input: BNC, 75 Ohms
- Monitor Output: BNC, 75 Ohms

Mechanical:

- Dimensions (without enclosure): 7" W x 9.5" H x 5.5" D
- Weight: 8lbs.